

Up Buffalo Creek  
 N. 31. W. 58  
 N. 77. W. 94  
 N. 66. W. 52. 204. P<sup>s</sup>

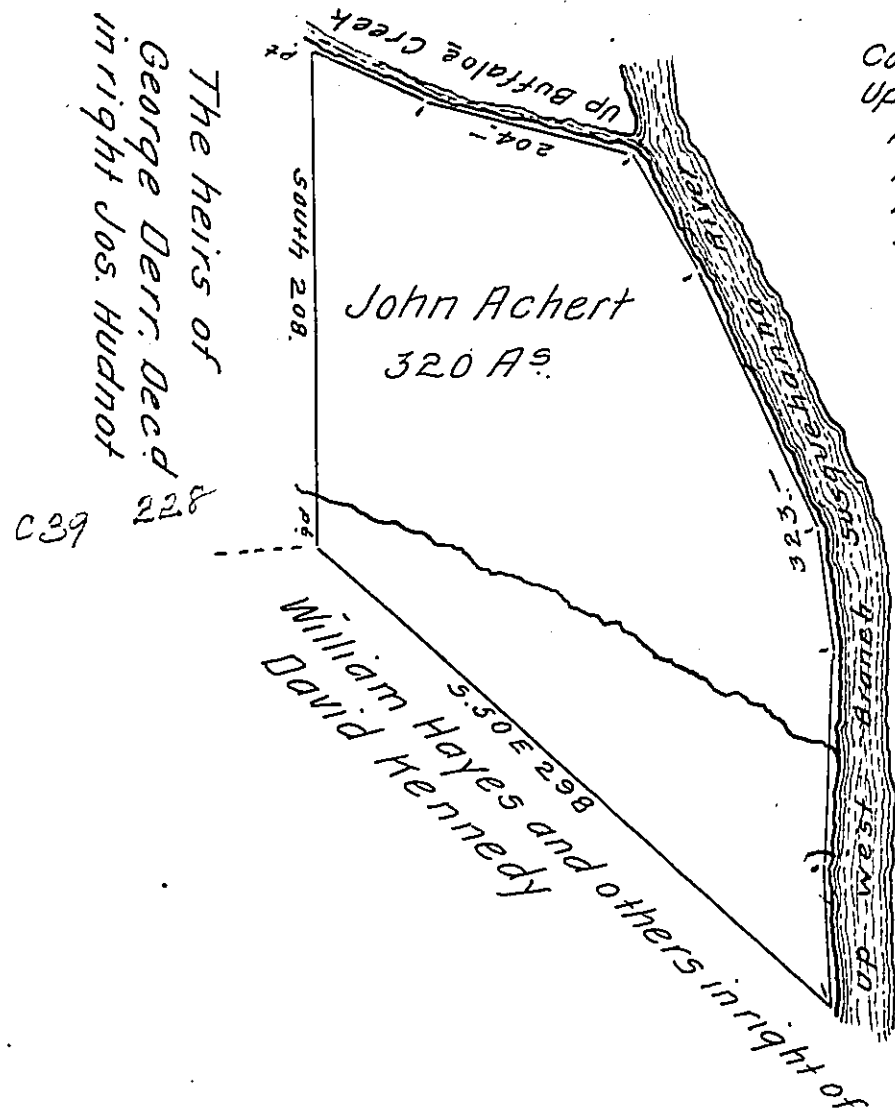

Courses & Distances  
 Up W. B. Susquehanna -  
 N. 5. W. 54  
 N. 3. E. 92.  
 N. 8. W. 50.  
 N. 25. W. 127.  
 323. P<sup>s</sup>

Situate in Buffalo township Union (late Berks) County Surveyed the 3<sup>d</sup> day of May 1833 by virtue of an Order granted to John Achert dated the 3<sup>d</sup> day of April 1769. N<sup>o</sup> 2721. Containing three hundred & twenty Acres with the Usual Allowance of Six per Cent &c.

The same was Surveyed the 28<sup>th</sup> February 1769 for Richard Peters by virtue of a Patent granted to Richard Peters dated the 11<sup>th</sup> of August A.D. 1772. for 320 Acres - The town of Lewisburg a part of the above described tract of land, the Residue is Divided into Lots and held by several persons in right of Richard Peters.

To Jacob Spangler Esq. }  
 Surveyor General. }

Jn<sup>o</sup> Hayes -

IN TESTIMONY that the above is a copy of the original remaining on file in the Department of Internal Affairs of Pennsylvania, made conformably to an Act of Assembly approved the 16th day of February, 1833, I have hereunto set my Hand and caused the Seal of said Department to be affixed at Harrisburg, this fifth day of February 1909.

*Henry Howell*  
 Secretary of Internal Affairs.